

Key #	Part #	Description
1	1001	HEX NUT M6 S/S
2	1002	FLAT WASHER 8MM DIA. S/S
3	1003	REFLECTOR
4	1004	LOCK WASHER 8MM DIA. S/S
5	1005	HEX BOLT M8 X 20MM S/S
6	1006	EMITTER GRID
7	1007	BURNER ASSEMBLY W/ SHIELD
8	1008	SHELF TAPPING SCREW M4 X 8MM S/S
9	1009	BURNER RETENTION SCREW
10	1010	BASE FTG FOR MAIN BURNER
11	1011	PAN HEAD SCREW M5 X 8MM
12	1012	PAN HEAD ASSEMBLY
13	1013	PERFORATED BODY
14	1014	PILOT SHIELD
15	1015	ELECTRODE
16	1016	PILOT ASSEMBLY
17	1017	IGNITER WIRE INSULATION
18	1018	THERMOCOUPLE
19	1019	PILOT TUBE ASSEMBLY
20	1020	ORIFICE FOR MAIN BURNER
21	1021	COMPRESSION FTG FOR ORIF.
22	1022	TUBE ASSEMBLY FOR BURNER
23	1023	THERMOELECTRIC VALVE
24	1024	EXTENSION FTG FOR VLV BASE
25	1025	BRACKET FOR VLV MOUNTING
26	1026	BRACKET FOR FUEL TUBE
27	1027	BASE ASSEMBLY FOR HEAD
28	1028	FLAT WASHER 6MM S/S
29	1029	LOCK WASHER 6MM DIA. S/S
30	1030	LIGHTING INSTRUCTION PLATE
31	1031	KNOB
32	1032	SPECIFIC NUT FOR VALVE
33	1033	PIEZO IGNITER
34	1034	PAN HEAD SCREW M6 X 12MM
35	1035	SPECIFIC NUT FOR IGNITER

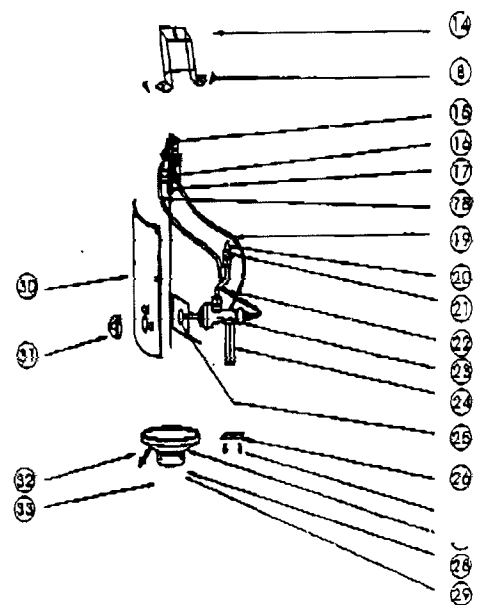

ITEM #	PART #	DESCRIPTION
1	2101	POST 3" X 36": JET
	3101	POST 3" X 36": WHITE
	4101	POST 3" X 36": S/S
	5101	POST 3" X 36": BRONZE
2	1102	FUEL FEEDLINE FOR POST
3	2103	SLIP SOCKET COVER: JET
	3103	SLIP SOCKET COVER: WHITE
	4103	SLIP SOCKET COVER: S/S
	5103	SLIP SOCKET COVER: BRONZE
4	1104	HEX BOLT M6 X 16MM S/S
5	1105	SAME AS #1028
6	2106	SOCKET ASSEMBLY: JET
	3106	SOCKET ASSEMBLY: WHITE
	4106	SOCKET ASSEMBLY: S/S
	5106	SOCKET ASSEMBLY: BRONZE
7	2107	"L" BRACKET F/SOCKET: JET
	3107	"L" BRACKET F/SOCKET: WHITE
	4107	"L" BRACKET F/SOCKET: S/S
	5107	"L" BRACKET F/SOCKET: BRONZE
8	1108	SAME AS #1029
9	1109	HEX NUT M6 STAINLESS STEEL
10	1110	CHAIN ASSEMBLY FOR TANK
11	1111	HEX BOLT M6 X 40MM S/S
12	2112	BASE W/MOLDING: JET
	3112	BASE W/MOLDING: WHITE
	4112	BASE W/MOLDING: S/S
	5112	BASE W/MOLDING: BRONZE
13	1113	BALLAST WEIGHT
14	1114	REGULATOR W/TYPE 1 QCC
15	1115	HOSE ASSEMBLY 3/8" FLARE
16	1116	MOLDING FOR DEC COVER
17	1117	MOLDING FOR TANK ACCESS
18	2118	DECORATIVE COVER: JET
	3118	DECORATIVE COVER: WHITE
	4118	DECORATIVE COVER: S/S
	5118	DECORATIVE COVER: BRONZE
19	2119	WHEEL W/BACKET (EACH): JET
	3119	WHEEL W/BACKET (EACH): WHITE
	4119	WHEEL W/BACKET (EACH): S/S
	5119	WHEEL W/BACKET (EACH): BRONZE
20	1105	SAME AS #1028
22	1122	PAN HEAD SCREW M6 X 12MM
23	1123	MOLDING FOR BOTTOM BASE

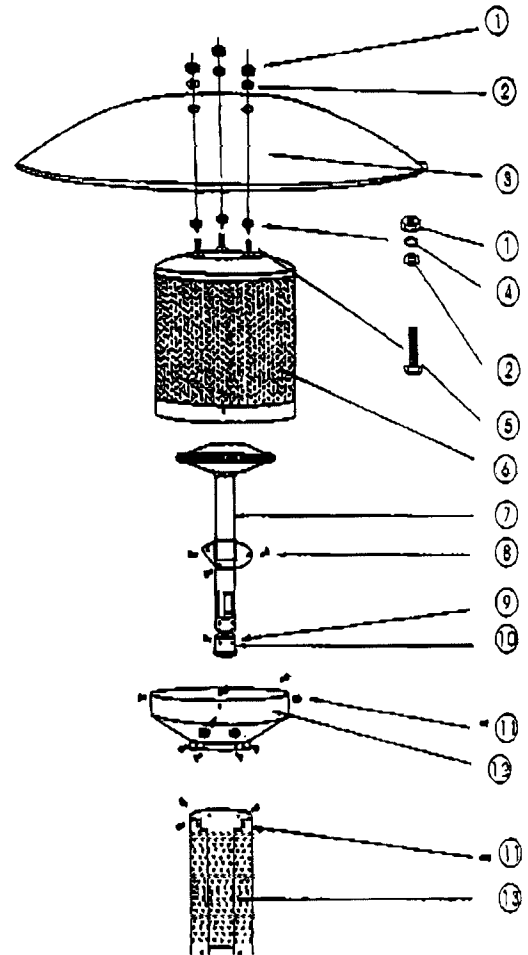